

Drain: SPRINGMILL STREAMS DRAIN **Drain #:** 159
Improvement/Arm: SPRINGMILL RIDGE - SECTION 3 - EXTENSION
Operator: JCH **Date:** 7-15-04
Drain Classification: Urban/Rural **Year Installed:** 1989

GIS Drain Input Checklist

- Pull Source Documents for Scanning JCH
- Digitize & Attribute Tile Drains N/A
- Digitize & Attribute Storm Drains JCH
- Digitize & Attribute SSD N/A
- Digitize & Attribute Open Ditch N/A
- Stamp Plans JCH
- Sum drain lengths & Validate JCH
- Enter Improvements into Posse JCH
- Enter Drain Age into Posse _____
- Sum drain length for Watershed in Posse _____
- Check Database entries for errors JCH

**Gasb 34 Footages for Historical Cost
Drain Length Log**

Drain-Improvement: SPRINGMILL STREAMS DRAIN - SPRINGMILL RIDGE - SECTION 3 - EXTENSION

Drain Type:	Size:	Length <i>SURVEYOR REPORT</i>	Length (DB Query)	Length Reconcile	If Applicable	
					Price:	Cost:
RCP	12"	200'	200'	Ø	\$ 7.25	\$ 1,450.00
	15"	165'	165'	Ø	9.50	1,567.50
Sum:		<u>365'</u>	<u>365'</u>	<u>Ø</u>		<u>\$ 3,017.50</u>

Final Report: _____

Comments:

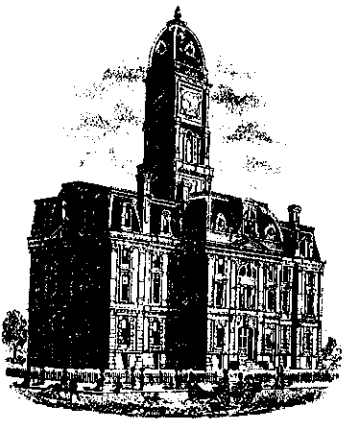

SURVEYOR'S OFFICE
Hamilton County

Kenton C. Ward, Surveyor
942 Maple Avenue
776-9626

Noblesville, Ind. 46060 March 16, 1989

To: Hamilton County Drainage Board

Re: Springmill Streams Drain
Springmill Ridge Section 3 Arm

Attached is a request to reconstruct the Springmill Ridge Arm of the Springmill Streams Drain. The request comes from the owners of the lots and the developer.

The request will add storm sewer in two locations. The first is along the rear of lots 50 and 51 running northeast from Str. 679. The second location is in the rear of lot 47 running generally northeast out of Str. 681. The change would add 200 feet of 12" RCP and 165 feet of 15" RCP. These changes are shown on the attached sheets 2 and 7 of the Springmill Ridge Section 3 Construction Plans. No change in the total length of drain will result in this alteration.

Upon review of the plans and calculations, I believe the change will improve the drainage facility. The work has been completed and upon inspection I found it to be acceptable. The recommendation to the Board is to set a hearing in May 1989 in order to establish these changes as part of the regulated drain for maintenance.

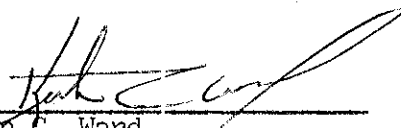
Kenton C. Ward,
Hamilton County Surveyor

CERTIFICATE OF COMPLETION AND COMPLIANCE

TO: Hamilton County Surveyor
FROM: Paul I. Cripe, Inc.
SUBJECT: Springmill Ridge, Section Three
Storm Sewer Extension

I hereby certify that

- 1) I am familiar with the plans and specifications for the above referenced project,
- 2) I have personally observed the completion of the above referenced project, and
- 3) To the best of my knowledge, information and belief, the above referenced project has been performed and completed in conformity with all plans and specifications, except as noted on record drawing dated 3/15/89.

Signature Joseph A. Sharp Date March 15, 1989
Type or Printed Name Joseph A. Sharp
Business Address 7172 Graham Road
Indianapolis, IN 46250
Telephone 842-6777

Seal

Indiana Registration Number

15179



ADM:t1
1/13/84

NOTE: CUTS SHOWN ARE APPROXIMATE
TAKEN FROM EXISTING GRADE
TO INV. OF PIPE.

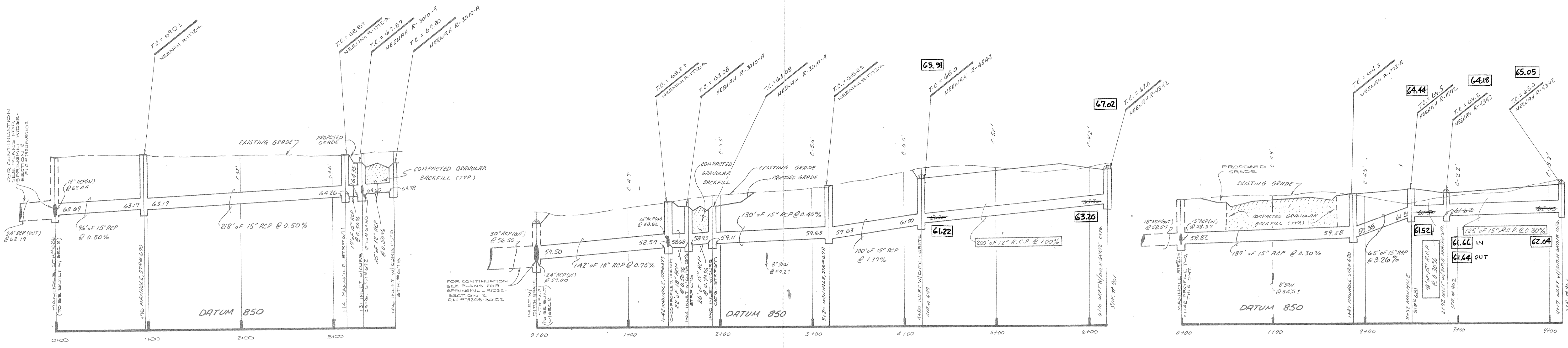

PROFILE ONE

PROFILE TWO

PROFILE THREE

* DENOTES PROPOSED
PIPE EXTENSIONS

NOTE:
FIELD ADJUSTMENT BY
ENGINEER MAY BE REQUIRED
AT ALL OUTFALL POINTS TO
INSURE PROPER OUTFALL
CONDITIONS.



This information was gathered for input
into the Hamilton County Geographical
Information System. This document is
considered an official record of the
GIS.
Entry Date: 7-15-04
Entered by: JDI

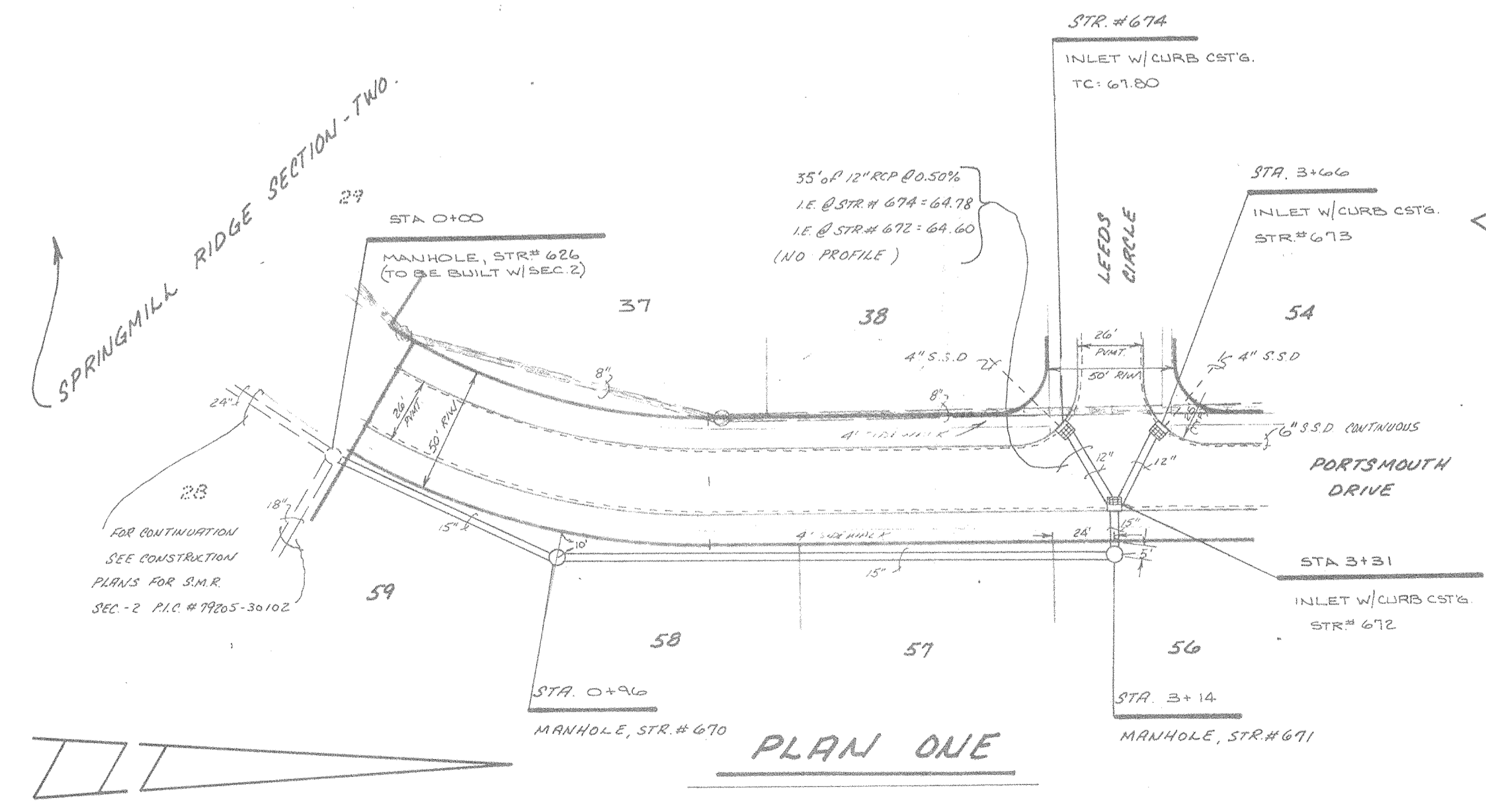

PLAN ONE

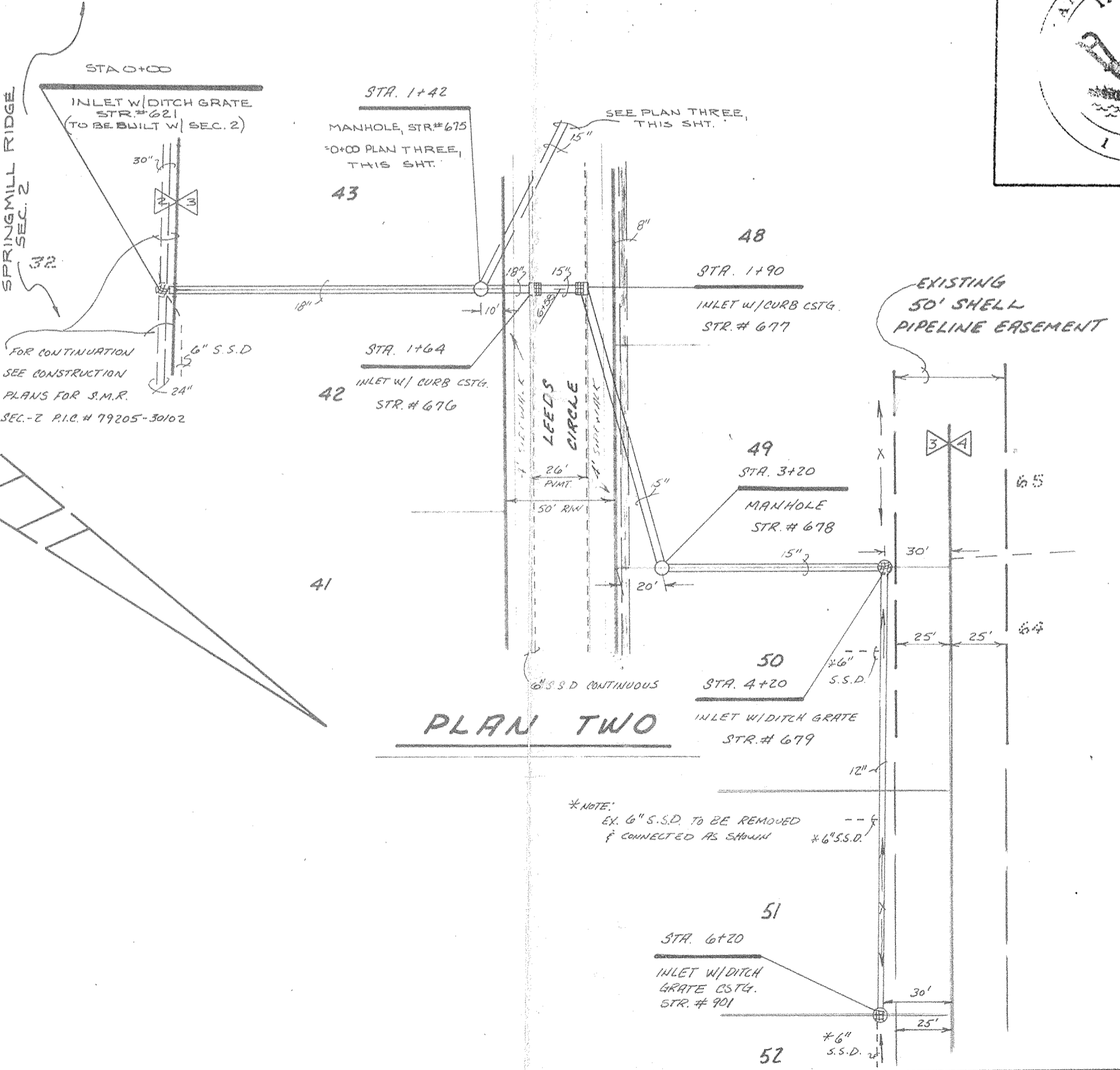

PLAN TWO

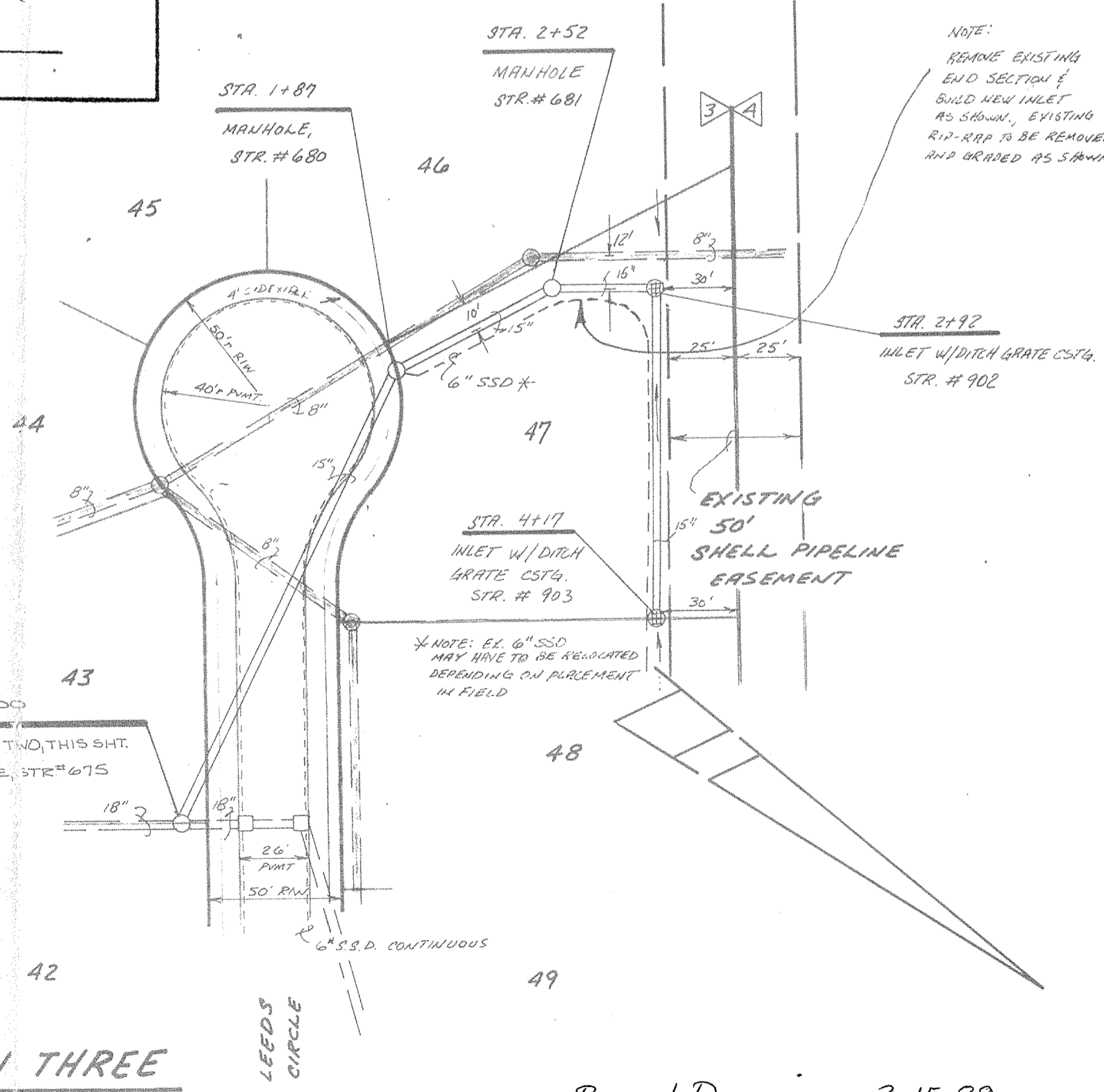

PLAN THREE

Record Drawing 3-15-89

CERTIFIED BY
Joseph H. Shaw
DATE 3/15/89

REVISIONS	DATE	DESCRIPTION
1	3-10-87	REV. PLAN & PROFILE THREE
2	3-11-88	ADDED PIPE & STRS. TO PLAN TWO & THREE
3	3-15-89	PROFILE TWO & THREE LOTS 50, 51, 97
4	3-15-89	IN-PLACE STM. SWR. EXTENSION

PAUL I. CRIFE, INC.
CIVIL ENGINEERING
LAND SURVEYING
ARCHITECTURE
LAND PLANNING

7172 GRAHAM ROAD
INDIANAPOLIS, INDIANA 46250
317-842-6777

TECH. CHK.	7/19
DFTNG. CHK.	

SCALE	DATE	CLIENT
1" = 30'	1-13-87	SPRINGMILL RIDGE SECTION - THREE
DRAWING TITLE		
STORM SEWER PLAN & PROFILE		

DWG. TYPE	FILE NUMBER	SHEET
		7
JOB NUMBER		OF 10
79205	30103	